



solutions  
mainten

# ESMS

## TECHNICAL SUBMITTAL

1. MACHINES
2. SPEED GOVERNOR
3. DOORS
4. RAILS GUIDE
5. INVERTER
6. ROPES
7. DATA CABLES



**Montanari Group**  
GEARLESS&GEARBOX  
TRACTION MACHINES

GEARLESS

**MGV25S**

**SMOU**

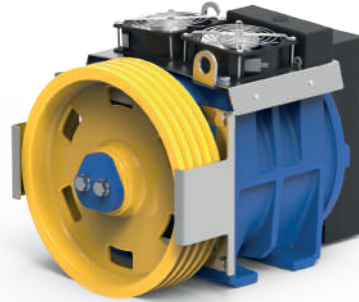

Momento Torcente Nominal Torque Torsions moment Drehmoment Par de Torsión	Coppia di corto circuito Short circuited torque Couple court-circuité Drehmoment kurzgeschlossen Par cortocircuitado	Poli Poles Poles Pole Polos	Encoder	Cavo motore Motor Cable Câble du moteur Motor Kabel Cable para motor
Nm	Nm			m
<b>250</b> S5 - 40% ED 240 s/h	300	16	Endat Sincos SSI BISS	7
<b>Freno - Brake - Frein - Bremse - Freno</b>				
RTW250 [2x270Nm] 2X79W - 207V <sub>DC</sub>				

**Telaio & Protezioni**  
**Bedplate & Safety guards**  
**Chassis & Protections**  
**Maschinenrahmen & Seilschützbügel**  
**Bancada & Protecciones**

#206

Gestisci il tuo gearless con:  
Manage your gearless with:  
Gérez votre gearless avec :  
Verwalten Sie Ihre Gearless mit:  
Gestiona tu gearless con:

**montanariapp**

MORE ON  
OUR WEBSITE



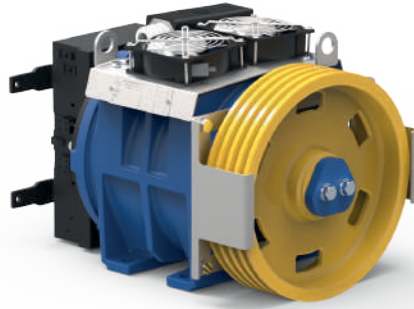

# MGV25S

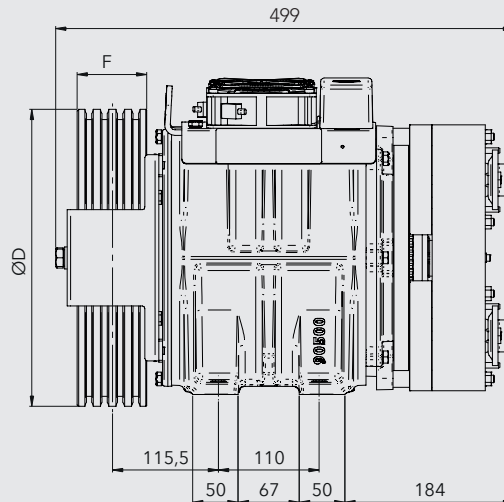
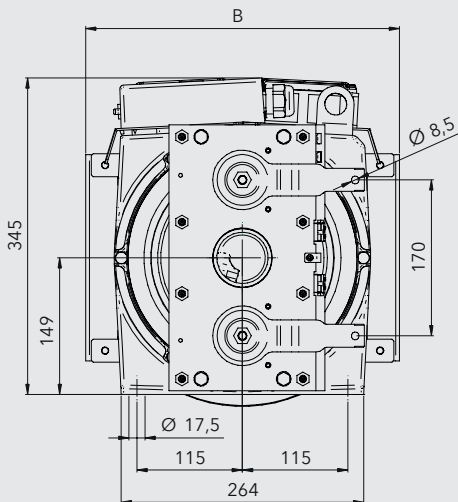
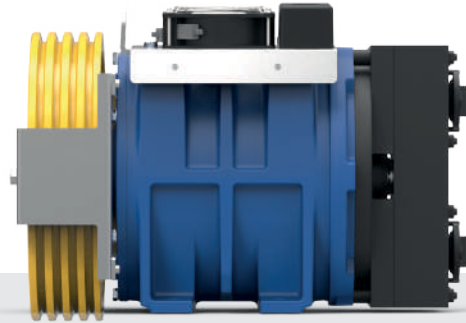

		Funi - Ropes - Cables Seilen - Cables			Dimensioni - Dimensions Mesures - Abmessungen - Tamaños
ØD	F	Ø	max	Pitch	B
mm		mm	n°	mm	mm
160	88	6 - 6,5	7	12	301
			8	9,5	
		8,1	6	12	
210	80	6 - 6,5	6	12	
			7 - 8	9,5	
240	80	6 - 6,5	6	12	
			7 - 8	9,5	
320	75	8	4	17	342
			5	13	



Portata Load Charge Nutzlast Carga		Ø	Coppia Torque Couple Drehmoment Par de torsión	Potenza Power Puissances Leistungen Potencia	Giri RPM Tours Drehzahl RPM	Freq.	Corrente Current Courant Strom Corriente	Macchina Machine Machine Maschinentyp Máquina	Corrente Current Courant Strom Corriente	Macchina Machine Machine Maschinentyp Máquina	
kg	m/s	mm	Nm	kW	RPM	Hz	A		A	***	
250	0,5	160	143	0,9	59,7	8,0	4,6	MGV25100603B500	8,2	MGV25101152B500	
		210	188	0,9	45,5	6,1	6,1	MGV25100603B500	10,8	MGV25101152B500	
		240	215	0,9	39,8	5,3	7,0	MGV25100603B500	9,4	MGV25100452B500	
		320	286	0,9	29,8	4,0	9,3	MGV25100603B500	13,0	MGV25100452B500	
	0,63	160	143	1,1	75,2	10,0	6,3	MGV25101203B500	8,2	MGV25101152B500	
		210	188	1,1	57,3	7,6	6,1	MGV25100603B500	10,8	MGV25101152B500	
		240	215	1,1	50,1	6,7	7,0	MGV25100603B500	12,3	MGV25101152B500	
		320	286	1,1	37,6	5,0	9,3	MGV25100603B500	13,0	MGV25100452B500	
	1	160	143	1,8	119,4	15,9	6,3	MGV25101203B500	10,9	MGV25102803B500	
		210	188	1,8	90,9	12,1	8,3	MGV25101203B500	10,8	MGV25101152B500	
		240	215	1,8	79,6	10,6	9,4	MGV25101203B500	12,3	MGV25101152B500	
		320	286	1,8	59,7	8,0	9,3	MGV25100603B500	16,0	MGV25101152B500	
	1,5	160	143	2,7	179,0	23,9	8,3	MGV25101923B500	16,9	MGV25105103B500	
		210	188	2,7	136,4	18,2	10,9	MGV25101923B500	16,5	MGV25101602B500	
		240	215	2,7	119,4	15,9	9,4	MGV25101203B500	16,3	MGV25102803B500	
		320	286	2,7	89,5	11,9	12,6	MGV25101203B500	16,0	MGV25101152B500	
	1,6	160	143	2,9	191,0	25,5	8,3	MGV25101923B500	16,9	MGV25105103B500	
		210	188	2,9	145,5	19,4	10,9	MGV25101923B500	16,5	MGV25101602B500	
		240	215	2,9	127,3	17,0	12,5	MGV25101923B500	18,8	MGV25101602B500	
		320	286	2,9	95,5	12,7	12,6	MGV25101203B500	16,0	MGV25101152B500	
	1,75	160	143	3,1	208,9	27,9	10,9	MGV25102803B500	16,9	MGV25105103B500	
		210	188	3,1	159,2	21,2	10,9	MGV25101203B500	16,5	MGV25101602B500	
		240	215	3,1	139,3	18,6	12,5	MGV25101923B500	18,8	MGV25101602B500	
		320	286	3,1	104,4	13,9	12,6	MGV25101203B500	16,0	MGV25101152B500	
2	160	143	3,6	238,7	31,8	10,9	MGV25102803B500	16,9	MGV25105103B500		
	210	188	3,6	181,9	24,3	10,9	MGV25101923B500	22,2	MGV25105103B500		
	240	215	3,6	159,2	21,2	12,5	MGV25101923B500	18,8	MGV25101602B500		
	320	286	3,6	119,4	15,9	12,6	MGV25101203B500	22,0	MGV25102803B500		
320	0,5	160	175	1,1	59,7	8,0	5,7	MGV25100603B500	10,1	MGV25101152B500	
		210	230	1,1	45,5	6,1	7,5	MGV25100603B500	13,2	MGV25101152B500	
		240	263	1,1	39,8	5,3	8,5	MGV25100603B500	12,0	MGV25100452B500	
	0,63	160	175	1,4	75,2	10,0	7,7	MGV25101203B500	10,1	MGV25101152B500	
		210	230	1,4	57,3	7,6	7,5	MGV25100603B500	13,2	MGV25101152B500	
		240	263	1,4	50,1	6,7	8,5	MGV25100603B500	15,0	MGV25101152B500	
	1	160	175	2,2	119,4	15,9	7,7	MGV25101203B500	13,3	MGV25102803B500	
		210	230	2,2	90,9	12,1	10,1	MGV25101203B500	13,2	MGV25101152B500	
		240	263	2,2	79,6	10,6	11,6	MGV25101203B500	15,0	MGV25101152B500	
	1,5	160	175	3,3	179,0	23,9	10,2	MGV25101923B500	20,7	MGV25105103B500	
		210	230	3,3	136,4	18,2	13,4	MGV25101923B500	20,2	MGV25101602B500	
		240	263	3,3	119,4	15,9	11,6	MGV25101203B500	20,0	MGV25102803B500	
	1,6	160	175	3,5	191,0	25,5	10,2	MGV25101923B500	20,7	MGV25105103B500	
		210	230	3,5	145,5	19,4	13,4	MGV25101923B500	20,2	MGV25101602B500	
		240	263	3,5	127,3	17,0	15,3	MGV25101923B500	23,1	MGV25101602B500	
	1,75	160	175	3,8	208,9	27,9	13,3	MGV25102803B500	20,7	MGV25105103B500	
		210	230	3,8	159,2	21,2	13,4	MGV25101923B500	20,2	MGV25101602B500	
		240	263	3,8	139,3	18,6	15,3	MGV25101923B500	23,1	MGV25101602B500	
	2	160	175	4,4	238,7	31,8	13,3	MGV25102803B500	20,7	MGV25105103B500	
		210	230	4,4	181,9	24,3	13,4	MGV25101923B500	27,0	MGV25105103B500	
		240	263	4,4	159,2	21,2	15,3	MGV25101923B500	23,1	MGV25101602B500	
	375	0,5	160	201	1,3	59,7	8,0	6,5	MGV25100603B500	11,5	MGV25101152B500
			210	264	1,3	45,5	6,1	8,5	MGV25100603B500	15,0	MGV25101152B500
		0,63	160	201	1,6	75,2	10,0	8,8	MGV25101203B500	11,5	MGV25101152B500
210			264	1,6	57,3	7,6	8,5	MGV25100603B500	15,0	MGV25101152B500	
1		160	201	2,5	119,4	15,9	8,8	MGV25101203B500	15,3	MGV25102803B500	
		210	264	2,5	90,9	12,1	11,6	MGV25101203B500	15,0	MGV25101152B500	
1,5		160	201	3,8	179,0	23,9	11,6	MGV25101923B500	23,7	MGV25105103B500	
		210	264	3,8	136,4	18,2	15,3	MGV25101923B500	23,1	MGV25101602B500	
1,6		160	201	4,0	191,0	25,5	11,6	MGV25101923B500	23,7	MGV25105103B500	
		210	264	4,0	145,5	19,4	15,3	MGV25101923B500	23,1	MGV25101602B500	
1,75		160	201	4,4	208,9	27,9	15,3	MGV25102803B500	23,7	MGV25105103B500	
		210	264	4,4	159,2	21,2	15,3	MGV25101923B500	23,1	MGV25101602B500	
2		160	201	5,0	238,7	31,8	15,3	MGV25102803B500	23,7	MGV25105103B500	
		210	264	5,0	181,9	24,3	15,3	MGV25101923B500	31,0	MGV25105103B500	

	Portata Load Charge Nutzlast Carga		Ø	Coppia Torque Couple Drehmoment Par de torsión	Potenza Power Puissances Leistungen Potencia	Giri RPM Tours Drehzahl RPM	Freq.	Corrente Current Courant Strom Corriente	Macchina Machine Machine Maschinentyp Máquina	Corrente Current Courant Strom Corriente	Macchina Machine Machine Maschinentyp Máquina		
	kg	m/s	mm	Nm	kW	RPM	Hz	A		A			
<b>1:1</b>	400	0,5	160	212	1,3	59,7	8,0	6,9	MGV25100603B500	12,2	MGV25101152B500		
			210	279	1,3	45,5	6,1	9,0	MGV25100603B500	16,0	MGV25101152B500		
		0,63	160	212	1,7	75,2	10,0	9,3	MGV25101203B500	12,2	MGV25101152B500		
			210	279	1,7	57,3	7,6	9,0	MGV25100603B500	16,0	MGV25101152B500		
		1	160	212	2,7	119,4	15,9	9,3	MGV25101203B500	16,1	MGV25102803B500		
			210	279	2,7	90,9	12,1	12,3	MGV25101203B500	16,0	MGV25101152B500		
		1,5	160	212	4,0	179,0	23,9	12,3	MGV25101923B500	25,1	MGV25105103B500		
			210	279	4,0	136,4	18,2	16,2	MGV25101923B500	24,4	MGV25101602B500		
		1,6	160	212	4,2	191,0	25,5	12,3	MGV25101923B500	25,1	MGV25105103B500		
			210	279	4,2	145,5	19,4	16,2	MGV25101923B500	24,4	MGV25101602B500		
		1,75	160	212	4,6	208,9	27,9	16,1	MGV25102803B500	25,1	MGV25105103B500		
			210	279	4,6	159,2	21,2	16,2	MGV25101923B500	24,4	MGV25101602B500		
		2	160	212	5,3	238,7	31,8	16,1	MGV25102803B500	25,1	MGV25105103B500		
			210	279	5,3	181,9	24,3	16,2	MGV25101923B500	33,0	MGV25105103B500		
		<b>2:1</b>	320	0,5	160	102	1,3	119,4	15,9	4,5	MGV25101203B500	7,7	MGV25102803B500
					210	133	1,3	90,9	12,1	5,9	MGV25101203B500	7,7	MGV25101152B500
240	152				1,3	79,6	10,6	6,7	MGV25101203B500	8,8	MGV25101152B500		
320	203				1,3	59,7	8,0	6,6	MGV25100603B500	11,7	MGV25101152B500		
0,63	160			102	1,6	150,4	20,1	5,9	MGV25101923B500	8,9	MGV25101602B500		
	210			133	1,6	114,6	15,3	5,9	MGV25101203B500	7,7	MGV25101152B500		
	240			152	1,6	100,3	13,4	6,7	MGV25101203B500	8,8	MGV25101152B500		
	320			203	1,6	75,2	10,0	8,9	MGV25101203B500	11,7	MGV25101152B500		
1	160			102	2,5	238,7	31,8	7,7	MGV25102803B500	12,0	MGV25105103B500		
	210			133	2,5	181,9	24,3	7,7	MGV25101923B500	15,8	MGV25105103B500		
	240			152	2,5	159,2	21,2	8,8	MGV25101923B500	13,4	MGV25101602B500		
	320			203	2,5	119,4	15,9	8,9	MGV25101203B500	15,4	MGV25102803B500		
1,5	160			102	3,8	358,1	47,7	9,0	MGV25103603B500				
	210			133	3,8	272,8	36,4	10,1	MGV25102803B500				
	240			152	3,8	238,7	31,8	11,6	MGV25102803B500	18,0	MGV25105103B500		
	320			203	3,8	179,0	23,9	11,8	MGV25101923B500	24,0	MGV25105103B500		
1,6	160			102	4,1	382,0	50,9	12,0	MGV25105103B500				
	210			133	4,1	291,0	38,8	10,1	MGV25102803B500				
	240			152	4,1	254,6	34,0	11,6	MGV25102803B500	18,0	MGV25105103B500		
	320			203	4,1	191,0	25,5	11,8	MGV25101923B500	24,0	MGV25105103B500		
1,75	160			102	4,4	417,8	55,7	12,0	MGV25105103B500				
	210			133	4,4	318,3	42,4	11,8	MGV25103603B500				
	240			152	4,4	278,5	37,1	11,6	MGV25102803B500				
	320			203	4,4	208,9	27,9	15,4	MGV25102803B500	24,0	MGV25105103B500		
2	160	102	5,1	477,5	63,7	12,0	MGV25105103B500						
	210	133	5,1	363,8	48,5	15,8	MGV25105103B500						
	240	152	5,1	318,3	42,4	13,5	MGV25103603B500						
	320	203	5,1	238,7	31,8	15,4	MGV25102803B500	24,0	MGV25105103B500				
2,5	210	133	6,3	454,7	60,6	15,8	MGV25105103B500						
	240	152	6,3	397,9	53,1	18,0	MGV25105103B500						
	320	203	6,3	298,4	39,8	18,0	MGV25103603B500						

Portata Load Charge Nutzlast Carga		Ø	Coppia Torque Couple Drehmoment Par de torsión	Potenza Power Puissances Leistungen Potencia	Giri RPM Tours Drehzahl RPM	Freq.	Corrente Current Courant Strom Corriente	Macchina Machine Machine Maschinentyp Máquina	Corrente Current Courant Strom Corriente	Macchina Machine Machine Maschinentyp Máquina	
kg	m/s	mm	Nm	kW	RPM	Hz	A		A		
400	0,5	160	120	1,5	119,4	15,9	5,3	MGV25101203B500	9,1	MGV25102803B500	
		210	158	1,5	90,9	12,1	6,9	MGV25101203B500	9,1	MGV25101152B500	
		240	180	1,5	79,6	10,6	7,9	MGV25101203B500	10,3	MGV25101152B500	
		320	240	1,5	59,7	8,0	7,8	MGV25100603B500	13,5	MGV25101152B500	
		0,63	160	120	1,9	150,4	20,1	7,0	MGV25101923B500	10,5	MGV25101602B500
			210	158	1,9	114,6	15,3	6,9	MGV25101203B500	9,1	MGV25101152B500
			240	180	1,9	100,3	13,4	7,9	MGV25101203B500	10,3	MGV25101152B500
			320	240	1,9	75,2	10,0	10,6	MGV25101203B500	13,5	MGV25101152B500
		1	160	120	3,0	238,7	31,8	9,1	MGV25102803B500	14,2	MGV25105103B500
			210	158	3,0	181,9	24,3	9,1	MGV25101923B500	18,6	MGV25105103B500
			240	180	3,0	159,2	21,2	10,4	MGV25101923B500	15,8	MGV25101602B500
			320	240	3,0	119,4	15,9	10,6	MGV25101203B500	18,2	MGV25102803B500
	1,5	160	120	4,5	358,1	47,7	10,6	MGV25103603B500			
		210	158	4,5	272,8	36,4	12,0	MGV25102803B500			
		240	180	4,5	238,7	31,8	13,7	MGV25102803B500	21,3	MGV25105103B500	
		320	240	4,5	179,0	23,9	13,9	MGV25101923B500	28,0	MGV25105103B500	
	1,6	160	120	4,8	382,0	50,9	14,2	MGV25105103B500			
		210	158	4,8	291,0	38,8	12,0	MGV25102803B500			
		240	180	4,8	254,6	34,0	13,7	MGV25102803B500	21,3	MGV25105103B500	
		320	240	4,8	191,0	25,5	13,9	MGV25101923B500	28,0	MGV25105103B500	
	1,75	160	120	5,3	417,8	55,7	14,2	MGV25105103B500			
		210	158	5,3	318,3	42,4	14,0	MGV25103603B500			
		240	180	5,3	278,5	37,1	13,7	MGV25102803B500			
		320	240	5,3	208,9	27,9	18,2	MGV25102803B500	28,0	MGV25105103B500	
	2	160	120	6,0	477,5	63,7	14,2	MGV25105103B500			
		210	158	6,0	363,8	48,5	18,6	MGV25105103B500			
		240	180	6,0	318,3	42,4	16,0	MGV25103603B500			
		320	240	6,0	238,7	31,8	18,2	MGV25102803B500	28,0	MGV25105103B500	
	2,5	210	158	7,5	454,7	60,6	18,6	MGV25105103B500			
		240	180	7,5	397,9	53,1	21,3	MGV25105103B500			
		320	240	6,9	298,4	39,8	21,0	MGV25103603B500			
	480	0,5	160	138	1,7	119,4	15,9	6,1	MGV25101203B500	10,5	MGV25102803B500
			210	182	1,7	90,9	12,1	8,0	MGV25101203B500	10,4	MGV25101152B500
			240	208	1,7	79,6	10,6	9,1	MGV25101203B500	11,9	MGV25101152B500
			320	277	1,7	59,7	8,0	9,0	MGV25100603B500	16,0	MGV25101152B500
		0,63	160	138	2,2	150,4	20,1	8,0	MGV25101923B500	12,1	MGV25101602B500
			210	182	2,2	114,6	15,3	8,0	MGV25101203B500	10,4	MGV25101152B500
			240	208	2,2	100,3	13,4	9,1	MGV25101203B500	11,9	MGV25101152B500
			320	277	2,2	75,2	10,0	12,2	MGV25101203B500	16,0	MGV25101152B500
		1	160	138	3,5	238,7	31,8	10,5	MGV25102803B500	16,4	MGV25105103B500
			210	182	3,5	181,9	24,3	10,5	MGV25101923B500	21,5	MGV25105103B500
			240	208	3,5	159,2	21,2	12,0	MGV25101923B500	18,2	MGV25101602B500
			320	277	3,5	119,4	15,9	12,2	MGV25101203B500	21,0	MGV25102803B500
		1,5	160	138	5,2	358,1	47,7	12,3	MGV25103603B500		
			210	182	5,2	272,8	36,4	13,8	MGV25102803B500		
			240	208	5,2	238,7	31,8	15,8	MGV25102803B500	24,6	MGV25105103B500
			320	277	5,2	179,0	23,9	16,1	MGV25101923B500	33,0	MGV25105103B500
1,6		160	138	5,5	382,0	50,9	16,4	MGV25105103B500			
		210	182	5,5	291,0	38,8	13,8	MGV25102803B500			
		240	208	5,5	254,6	34,0	15,8	MGV25102803B500	24,6	MGV25105103B500	
		320	277	5,5	191,0	25,5	16,1	MGV25101923B500	33,0	MGV25105103B500	
1,75		160	138	6,1	417,8	55,7	16,4	MGV25105103B500			
		210	182	6,1	318,3	42,4	16,1	MGV25103603B500			
		240	208	6,1	278,5	37,1	15,8	MGV25102803B500			
		320	277	6,1	208,9	27,9	21,1	MGV25102803B500	33,0	MGV25105103B500	
2		160	138	6,9	477,5	63,7	16,4	MGV25105103B500			
		210	182	6,9	363,8	48,5	21,5	MGV25105103B500			
		240	208	6,9	318,3	42,4	18,4	MGV25103603B500			
		320	277	6,9	238,7	31,8	21,1	MGV25102803B500	33,0	MGV25105103B500	
2,5		210	182	8,7	454,7	60,6	21,5	MGV25105103B500			
		240	208	8,7	397,9	53,1	24,6	MGV25105103B500			
		320	277	6,9	298,4	39,8	25,0	MGV25103603B500			

Portata Load Charge Nutzlast Carga		Ø	Coppia Torque Couple Drehmoment Par de torsión	Potenza Power Puissances Leistungen Potencia	Giri RPM Tours Drehzahl RPM	Freq. Hz	Corrente Current Courant Strom Corriente	Macchina Machine Machine Maschinentyp Máquina	Corrente Current Courant Strom Corriente	Macchina Machine Machine Maschinentyp Máquina
			Nm	kW	RPM		A	A		
630	0,5	160	173	2,2	119,4	15,9	7,6	MGV25101203B500	13,2	MGV25102803B500
		210	227	2,2	90,9	12,1	10,0	MGV25101203B500	13,1	MGV25101152B500
		240	260	2,2	79,6	10,6	11,4	MGV25101203B500	15,0	MGV25101152B500
	0,63	160	173	2,7	150,4	20,1	10,0	MGV25101923B500	15,2	MGV25101602B500
		210	227	2,7	114,6	15,3	10,0	MGV25101203B500	13,1	MGV25101152B500
		240	260	2,7	100,3	13,4	11,4	MGV25101203B500	15,0	MGV25101152B500
	1	160	173	4,3	238,7	31,8	13,2	MGV25102803B500	20,5	MGV25105103B500
		210	227	4,3	181,9	24,3	13,2	MGV25101923B500	27,0	MGV25105103B500
		240	260	4,3	159,2	21,2	15,1	MGV25101923B500	22,8	MGV25101602B500
	1,5	160	173	6,5	358,1	47,7	15,3	MGV25103603B500		
		210	227	6,5	272,8	36,4	17,3	MGV25102803B500		
		240	260	6,5	238,7	31,8	19,7	MGV25102803B500	31,0	MGV25105103B500
	1,6	160	173	6,9	382,0	50,9	20,5	MGV25105103B500		
		210	227	6,9	291,0	38,8	17,3	MGV25102803B500		
		240	260	6,9	254,6	34,0	19,7	MGV25102803B500	31,0	MGV25105103B500
	1,75	160	173	7,6	417,8	55,7	20,5	MGV25105103B500		
		210	227	7,6	318,3	42,4	20,1	MGV25103603B500		
		240	260	7,6	278,5	37,1	19,7	MGV25102803B500		
	2	160	173	8,7	477,5	63,7	20,5	MGV25105103B500		
		210	227	8,7	363,8	48,5	26,9	MGV25105103B500		
		240	260	8,7	318,3	42,4	23,0	MGV25103603B500		
	2,5	210	227	10,5	454,7	60,6	27,0	MGV25105103B500		
		240	260	9,2	397,9	53,1	31,0	MGV25105103B500		
	700	0,5	160	189	2,4	119,4	15,9	8,3	MGV25101203B500	14,4
210			248	2,4	90,9	12,1	10,9	MGV25101203B500	14,0	MGV25101152B500
0,63		160	189	3,0	150,4	20,1	11,0	MGV25101923B500	16,6	MGV25101602B500
		210	248	3,0	114,6	15,3	10,9	MGV25101203B500	14,0	MGV25101152B500
1		160	189	4,7	238,7	31,8	14,4	MGV25102803B500	22,4	MGV25105103B500
		210	248	4,7	181,9	24,3	14,4	MGV25101923B500	29,0	MGV25105103B500
1,5		160	189	7,1	358,1	47,7	16,8	MGV25103603B500		
		210	248	7,1	272,8	36,4	18,9	MGV25102803B500		
1,6		160	189	7,6	382,0	50,9	22,4	MGV25105103B500		
		210	248	7,6	291,0	38,8	18,9	MGV25102803B500		
1,75		160	189	8,3	417,8	55,7	22,4	MGV25105103B500		
		210	248	8,3	318,3	42,4	22,0	MGV25103603B500		
2		160	189	9,5	477,5	63,7	22,4	MGV25105103B500		
		210	248	9,5	363,8	48,5	29,4	MGV25105103B500		
2,5		210	248	10,5	454,7	60,6	29,0	MGV25105103B500		

**Fig. 2**  
**NOR - Tab 170**

INSTALLATION  
HANDSIDE DX

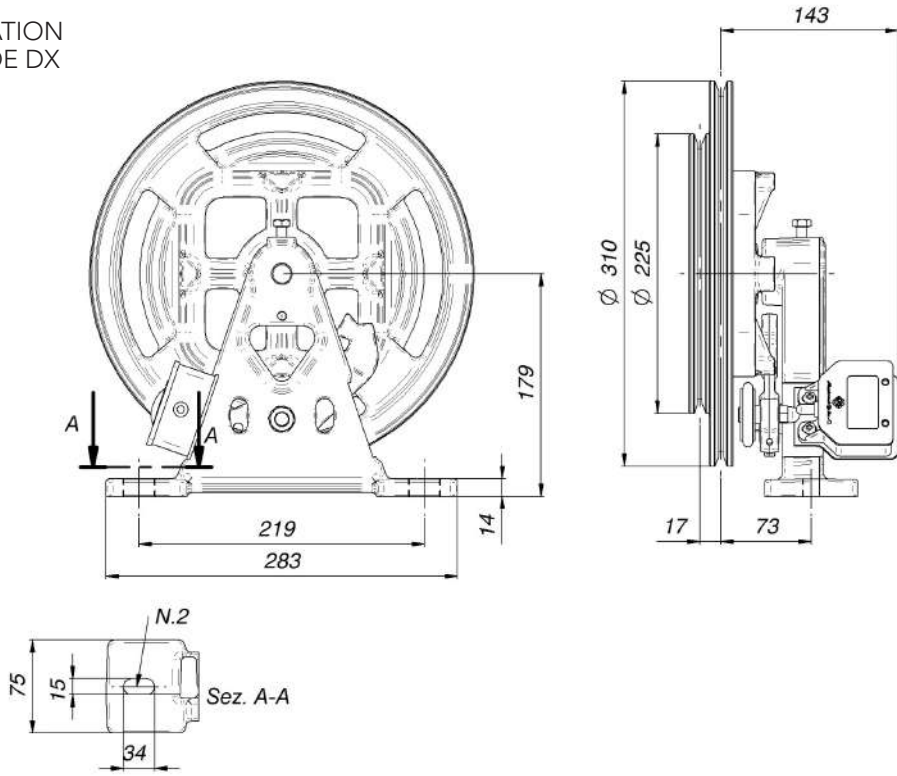

**Fig. 3**  
**RG200 - Tab 131**

INSTALLATION  
HANDSIDE DX  
STANDARD BASE

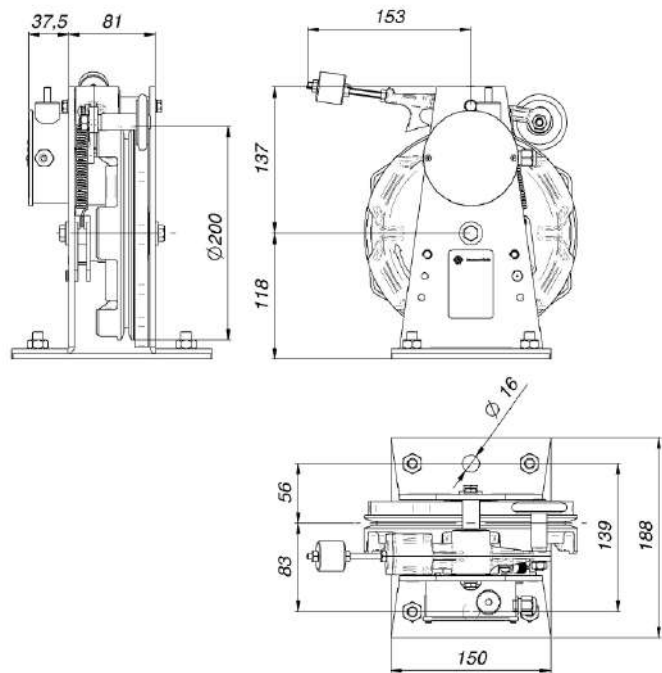
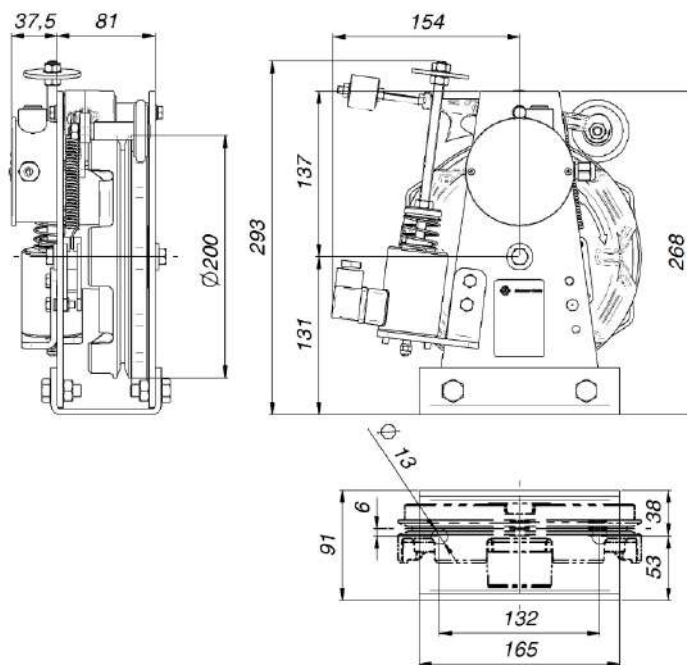

Fig. 4  
RG200 - Tab 139

INSTALLATION  
HANDSIDE DX  
NARROW BASE



## 4. TRANSPORT AND STORAGE

### 4.1 Handling

Different types of packaging can be used, depending on the size and means of transport. Unless otherwise specified, the packaging complies with the HPE guidelines.

It is recommended to verify also the condition of the goods upon receipt. In case of damages do not proceed with installation except for Montanari Giulio & C. authorization.

Comply with the symbols on the packaging to prevent damage to property or personal injury. Here are the meanings of the symbols that may appear on the packaging.



Keep dry



Handle with care



Attachment point



Upper side



Do not use hooks



Keep away from heat sources



Fragile



Center of gravity



*For rising, only use pins/spacers shown in the figure.  
Never lubricate or grease mechanical components!  
Deposits of dirt and dust can compromise the correct operation.*

Fig. 5

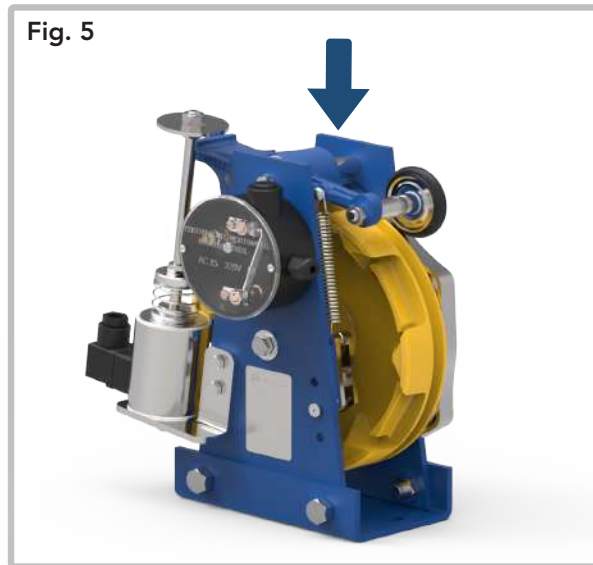

### 4.2 Storage



*The unit must be kept in a closed and dry environment.*



*Supplies for special environmental conditions during transport (e.g. by ship) and storage (climate, temperature, etc.) must be contractually agreed.*

## 5. DESCRIPTION AND OPERATION

### 5.1 General description

The speed governor is a safety device that trips when the car reaches the intervention speed at which it is calibrated.

Governor:

- One-way - it operates the safety gear lever in its downwards movement.
- Two-way - it operates in both travel direction.

The speed governor is designed for detecting the excess speed and to intervene both mechanically and electrically as below described:

- the mechanical part activates the safety gear
- the electric part stops the lift drive

 **See detail in paragraph 5.4**



**Note:** A tension device is required to tension the speed governor rope (see for example TAB163.1 and TEV on product general catalogue of Montanari Giulio & C.)

### 5.2 Components

The following figures show the parts forming the NOR - RG - RH governor in standard version.

NOR - Tab 170

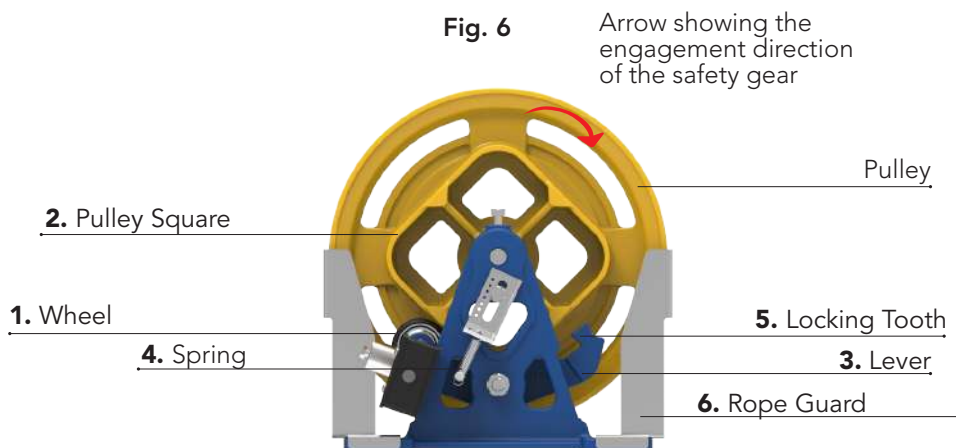



Test groove

Fig. 7

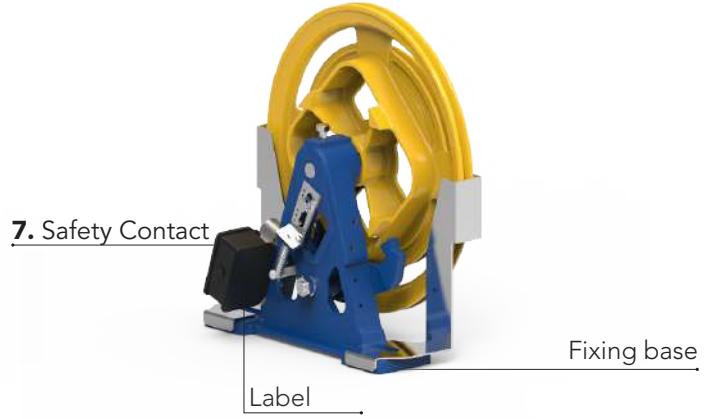

7. Safety Contact

Label

Fixing base

Fig. 8

RG200 - Tab 170

Fig.9

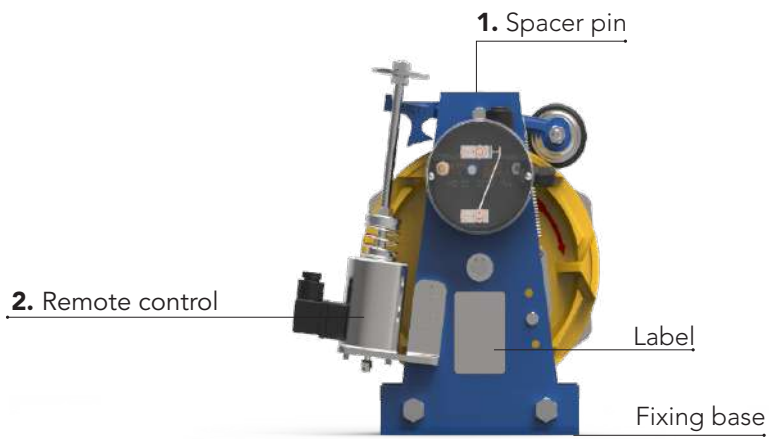
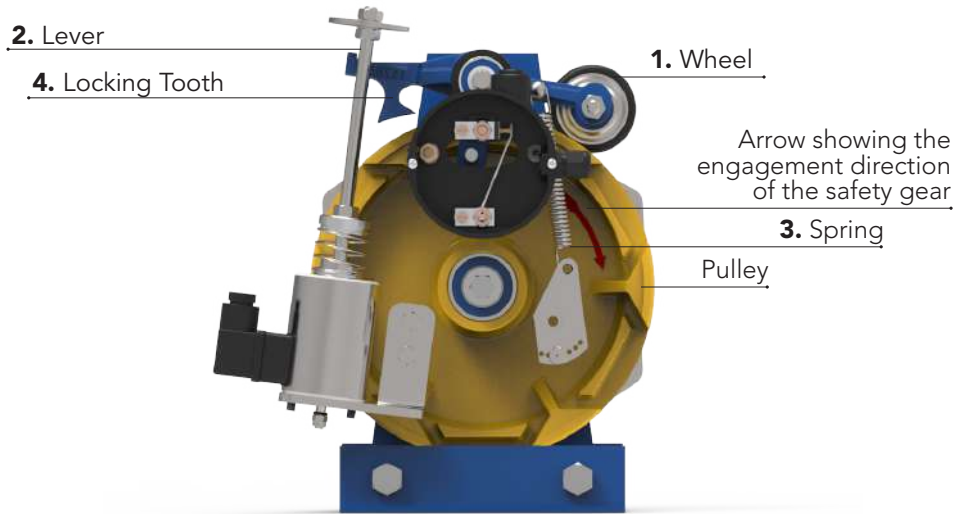

Fig. 10



**FIXING:** The speed governor must be fixed checking its vertical direction with a bubble level or a lead wire.

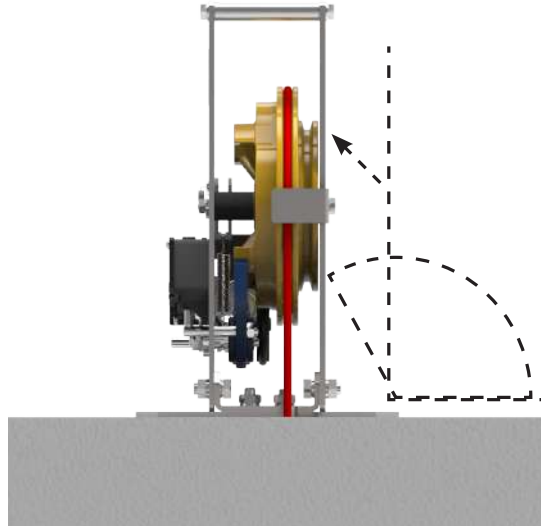

Fig. 11



**MAX. ALLOWED SLOPING:** The speed governor must be installed so that the rope runs parallel in the pulley groove. The rope max. recommended sloping (A) is  $\pm 0.50^\circ$ .

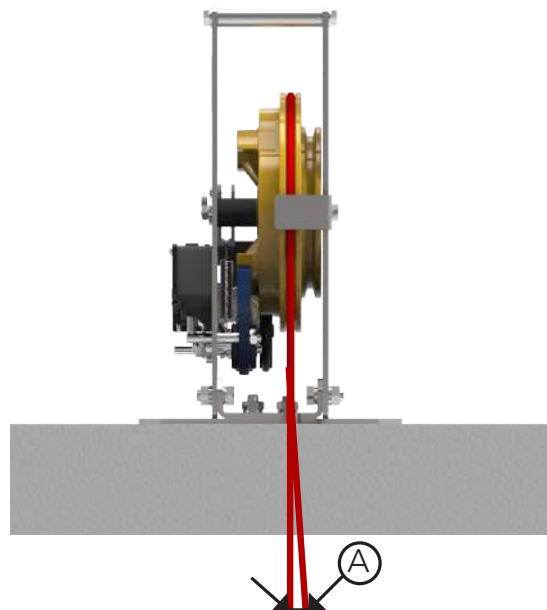

Fig. 12



## 6.2 Installation of ropes

The speed governor only works in a perfect way if rope and tension device are correctly installed.

1. Gather the rope close to the governor and thread one head through the governor towards the safety gear levers.
2. Connect the first rope attachment to the same rope and secure it to the safety gear lever.
3. Install the tension device following its installation instructions.
4. Connect the second head of the rope - passing through the tension device - to the rope attachment and then to the safety gear lever.

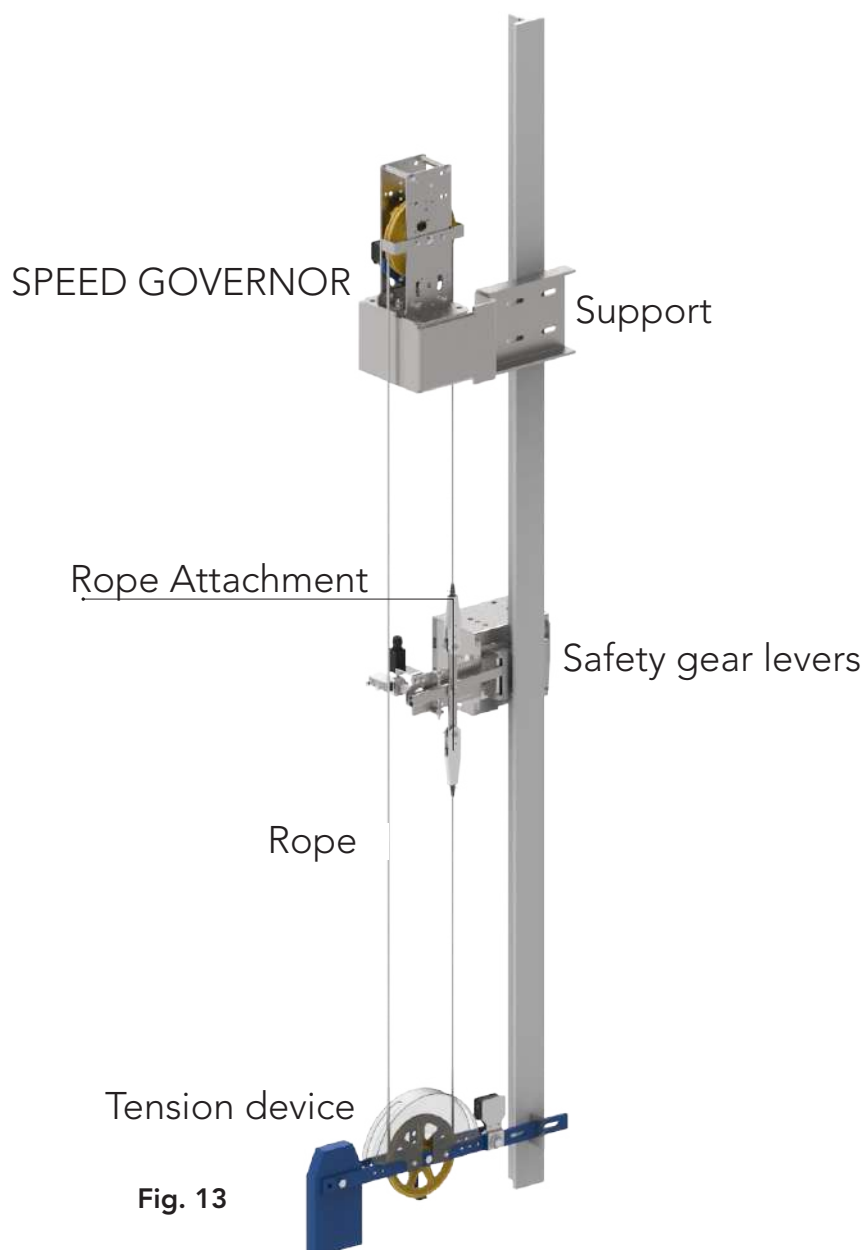

Fig. 13

### 6.3 Electrical installation - Excess speed contact



**FIXING: Before proceeding, cut power off**

Note down the following while laying the connecting cable:

- **single-pin cables must have a double insulation**
- **use and laying of cables must follow the regulations in force**

Fig. 14

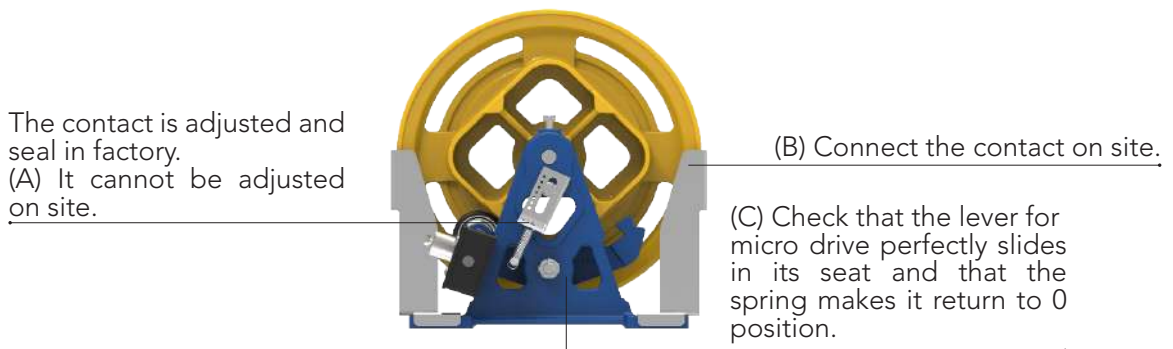

(D) Test the operation of the contact, at the end reset it in case of manual reset.

## 7. INSTALLATION OF SPEED GOVERNORS WITH OPTIONAL ACCESSORIES

### 7.1 Electrical installation of the **REMOTE CONTROL**

**IMPORTANT:**

The remote control is necessary in case of governor installation in inaccessible areas as specified by the standard  **see paragraph 3.2**

The remote control allows the governor pulley to be stopped during downwards movement for one-way versions and in both directions for two-way versions.

Electrical features of the electromagnet	
REMOTE CONTROL	12 VDC / 7 A, ED20%
	24 VDC / 3.7 A, ED20%
	48 VDC / 1.85 A, ED20%
	230 VAC / 0.66 A, ED20%

Tab. 6

# Wittur doors



Fast installation

## Essential Augusta EVO

Augusta EVO is our affordable quality door for the residential market. Its effective design means amazingly easy and fast installation and maintenance.



Many options available

## Flexible C-MOD

C-MOD combines compactness with high flexibility. Its different installations options make it suitable for any residential elevator.



Unlimited possibilities

## Multipurpose Hydra

Hydra is our multifunctional door designed for maximum application flexibility. It features an almost unlimited range of executions and options.



Reliable

## Reliable Pegasus

Pegasus is a multifunctional elevator door capable of withstanding heavy traffic in hotels, public buildings, hospitals and shopping centres.



Fast and quiet operation

## High performance B-HR

The ideal solution for high-rise elevators. It guarantees extremely fast opening combined with quiet and smooth operation. Elevator door technology at its best!



Vandal resistant Cat.2

## Heavy duty B-G

A door designed for industrial and freight elevators. Reinforced vandal resistant components and sturdy design guarantee safety and reliability at all times.



85 or 115 mm sill package

## Compact sill Fineline®

Fineline incomparable compact sill design contributes to space saving: it can fit even in the smallest shafts.



High quality modernization

## Modernization Hydra 3000

Hydra 3000 ensures high flexibility especially for elevator modernization purposes. Its small size guarantees a high adaptability and fits itself perfectly to all shaft conditions.



Very limited weight and dimensions

## Folding car door ECO BUS

ECO BUS is our light folding car door for modernization. Usually coupled with swing doors, it is perfect for those jobs that call for a car door with very limited weight and dimensions.

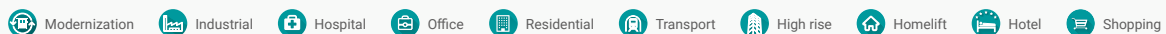









WITTUR GROUP Elevator Doors

# Comparison chart

	Augusta EVO	C-MOD	Hydra	Pegasus	B-HR	B-G	Fineline®	Hydra 3000	ECO BUS
	Up to 3 m/s	Up to 2 m/s	Up to 6 m/s	Up to 10 m/s	Up to 10 m/s	Up to 3 m/s	Up to 2 m/s	Up to 4 m/s	Up to 2 m/s
Clear opening (mm)	700 - 1100	600 - 1400	500 - 3200	600 - 3200	800 - 2400	1000 - 3500	600 - 900	600 - 1200	500 - 1100
Clear height (mm) *	2000 - 2200	2000 - 2300	2000 - 3500	2000 - 3800	2000 - 3000	2000 - 3500	1900 - 2100	1900 - 2100	2000 - 2100
C2 / Sill package (mm)	110	117	180	180	200	165	85	130	-
T2 / Sill package (mm)	190	185	210	210	265	255	115	180	-
T3 / Sill package (mm)	-	273	256 / 302	303	-	345	-	236	-
C4 / Sill package (mm)	-	185	210	210	265	255	Symmetrical 115 / Asymmetrical 115	180	130
C6 / Sill package (mm)	-	-	302	302	-	345	-	-	-
T1 / Sill package (mm)	-	-	180	180	-	-	-	-	-
Full glass	-	-	○	○	○ (only for B-HR Low)	○	-	-	-
Framed Glass	-	○	○	○	○	○	-	-	-
EN 81-20/50	●	●	●	●	●	●	●	●	●
EN 81-71	-	○ Cat. 1	○ Cat. 1	○ Cat 1, ○ Cat 2	○ Cat 1	○ Cat 1, ○ Cat 2	○ Cat 1	-	-
EN 81-72	-	○	○	○	○	○	-	-	-
EN 81-58 E	●	○	○	●	○	○	○	○	-
EN 81-58 EI	○	○	○	○	○	○	-	○	-
BS 476 E	○	-	○	○	○	○	-	-	-
EN 81-58 EW	○	○	○	○	○	○	○	○	-
UKCA	●	●	●	●	●	●	●	●	●
Aluminium sill	●	●	●	●	●	●	●	●	●
Reinforced sill	-	○	○	○ St. Steel / Bronze	○	○ St. Steel / Bronze	-	-	-
Hidden sill	-	-	○	-	-	-	-	-	-
Door closing	Spring	Spirator, Counterweight	Spring / Counterweight	Spring / Counterweight	Spirator, Counterweight (B-HR MED/TOP), Spring (B-HR LOW)	Spirator Counterweight	Counterweight	Spring Standard / Counterweight option C2 & C4	Spring
Light curtain	Fixed	Fixed	Fixed and dynamic	Fixed and dynamic	Dynamic	Fixed and dynamic	Fixed	Fixed and dynamic	Fixed and dynamic
IP54	-	○	○	○	○	○	-	○	-
Door Drive	ECO+	ECO+ MIDI+ SDS	ECO+ MIDI+ SUPRA	MIDI+ SUPRA	SDS SDS HV SDS MV	SDS SDS MV	ECO+	ECO+ MIDI+	ECO+

## Door Drive

Augusta EVO	ECO+		B-HR	SDS, SDS HV, SDS MV	
C-MOD	SDS, ECO+, MIDI+		B-G	SDS, SDS MV	
Hydra	ECO+, MIDI+, SUPRA		Fineline®	ECO+	
Pegasus	MIDI+, SUPRA		Hydra 3000	ECO+, MIDI+	

\* Depends from C.O.

● Supplied ○ Optional

Elevator Doors WITTUR GROUP



# Comparison chart

## Flexible engineering and operations excellence

Wittur has been developing special elevator doors for more than 40 years. We work as partners in special projects to provide doors which fit with the original vision of the architect. At the same time we provide industrialised components with the same lifecycle and the same safety level of standard elevator doors.



	Luna	Nettuno	Taurus	SWS
	Up to 3 m/s	Up to 3 m/s	Up to 3 m/s	Up to 3,5 m/s
<b>Clear opening (mm)</b>	600 - 1800	600 - 3200	800 - 5000	800 - 1200
<b>Clear height (mm) *</b>	2000 - 3000	2000 - 3000	2000 - 5000	2000 - 2200
<b>C2 / Sill package (mm)</b>	Underdriven 180 / Top driven 186	180	180	240
<b>T2 / Sill package (mm)</b>	–	270	276	290
<b>T3 / Sill package (mm)</b>	–	–	394	–
<b>C4 / Sill package (mm)</b>	–	270	276	290
<b>C6 / Sill package (mm)</b>	–	–	394	–
<b>T1 / Sill package (mm)</b>	Underdriven 180 / Top driven 186	180	–	–
<b>Full glass</b>	○	○	–	–
<b>Framed Glass</b>	○	○	○	○
<b>EN 81-20/50</b>	●	●	●	●
<b>EN 81-71</b>	–	–	–	○ Cat 1, ○ Cat 2
<b>EN 81-72</b>	–	○	○	○
<b>EN 81-58 E</b>	○	○	○	○
<b>EN 81-58 EI</b>	–	–	○	○
<b>BS 476 E</b>	○	○	○	–
<b>Aluminium sill</b>	–	–	–	●
<b>Reinforced sill</b>	●	●	●	○
<b>Hidden sill</b>	–	–	–	○
<b>Door closing</b>	Spring	Spirator	Counterweight	Spirator
<b>Light curtain</b>	Fixed and dynamic	Fixed and dynamic	Fixed and dynamic	Fixed and dynamic
<b>IP54</b>	○	○	○	○
<b>Door Drive</b>	SUPRA	MIDI+ SUPRA	Industrial motor	SDS, SWS + IRDA

**Standard Cold Drawn Guide Rails**

Reference Norm: ISO 7465: 1997(E) – Raw material: E 235 B (ISO 630: 1995), corresponding to Fe 360 B. Guide rail length: 5,000 mm ± 2mm  
 Different length according to customer's requirements. Different guide rail sections and specifications: according to definition with customers.

**DIMENSIONS**

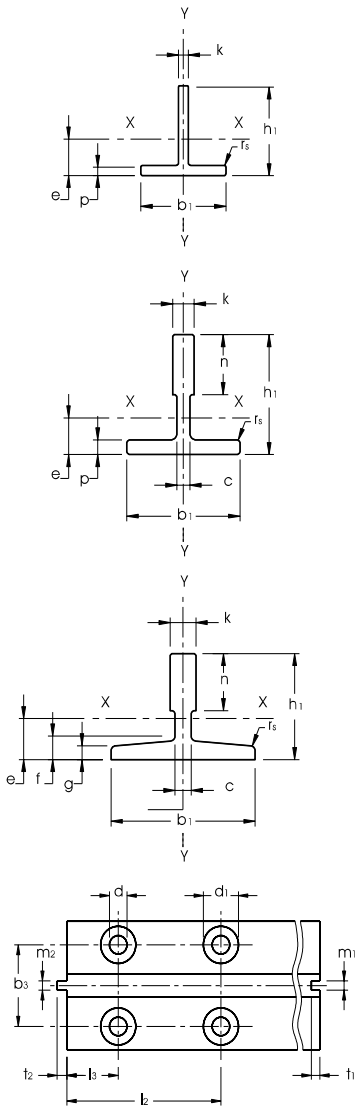

Monteferro Code	ISO Code	b <sub>1</sub> mm	h <sub>1</sub> mm	k mm	n mm
Tolerances		±0.5	±0.2	±0.15	
RT 40	—	40	40	5	
RT 45	T 45/A	45	45	5	
RT 45 M/F	—	45	45	5	
RT 50	T 50/A	50	50	5	
RT 50 M/F	—	50	50	5	
Tolerances		±1.5	±0.1	+0.1/0	+3/0
RT 70	T 70-2/A	70	70	8	
RT 80	—	80	80	9	
Tolerances		±1.5	±0.1	+0.1/0	+3/0
RF 50	—	50	50	9	35
RF 70	T 70-1/A	70	65	9	34
RF 70.9	—	70	70	9	35
RF 75	T 75-3/A	75	62	10	30
Tolerances		±1.5	±0.1	+0.1/0	+3/0
RF 65	—	65	54	7.9	20
RF 82	T 82/A	82.5	68.25	9	25.4
RF 89	T 89/A	89	62	15.88	33.4
RF 90	T 90/A	90	75	16	42

**KEY FACTORS**

**Blade finish**

longitudinal 1.6 Ra ≤ 63μ  
 transverse 1.6 Ra ≤ 126μ

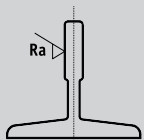

**Straightness**

B/A = 0.001  
 B<sub>max</sub> (5m) = 2 mm  
 B<sub>1m</sub> = 0.5 mm

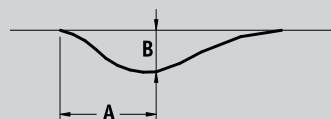

**Twisting**

γ = 40'/m

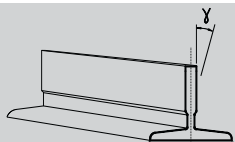

**Parallelism**

ρ = 0.15 mm

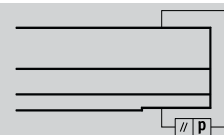

**Perpendicularity**

α = 10'  
 β = 15'

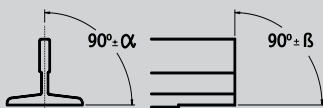

**Tongue and groove centering**

c = 0.1 mm

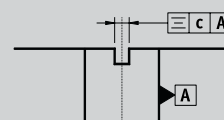

p	g	f	r <sub>s</sub>	m <sub>1</sub>	m <sub>2</sub>	t <sub>1</sub>	t <sub>2</sub>	d	d <sub>1</sub>	b <sub>3</sub>	l <sub>2</sub>	l <sub>3</sub>
mm	mm	mm	mm	mm	mm	mm	mm	mm	mm	mm	mm	mm
±0.5				+0.06/-0	+0/-0.06	±0.1	±0.1			±0.2	±0.2	±0.2
5			1	2	1.95	2.5	2	9		23	85	15
5			1					9		25	65	15
5			1	2	1.95	2.5	2	9		25	65	15
5			1					9		30	75	25
5			1	2	1.95	2.5	2	9		30	75	25
±0.75				+0.06/-0	+0/-0.06	±0.1	±0.1			±0.2	±0.2	±0.2
8			1.5	3	2.95	3.5	3	13		42	105	25
9			1.5	3	2.95	3.5	3	13		42	105	25
±0.75				+0.06/-0	+0/-0.06	±0.1	±0.1			±0.2	±0.2	±0.2
6.5			1	3	2.95	3.5	3	9		30	75	25
7			1.5	3	2.95	3.5	3	13		42	105	25
8.5			1.5	3	2.95	3.5	3	13		43	90	30
7.5			1.5	3	2.95	3.5	3	13		43	90	30
±0.75	±0.75			+0.06/-0	+0/-0.06	±0.1	±0.1		*	±0.2	±0.2	±0.2
4	6	1.5	2	1.95	2.5	2	10	24*	40	65	15	
6	8.25	3	3	2.95	3.5	3	13	26*	50.8	81	27	
7.9	11.1	3	6.4	6.37	7.14	6.35	13	26*	57.2	114.3	38.1	
8	10	4	6.4	6.37	7.14	6.35	13	26*	57.2	114.3	38.1	

\*on demand

### TECHNICAL CHARACTERISTICS

Monteferro Code	ISO Code	s	q <sub>1</sub>	e	i <sub>xx</sub>	w <sub>xx</sub>	i <sub>xx</sub>	I <sub>yy</sub>	w <sub>yy</sub>	i <sub>yy</sub>
		cm <sup>2</sup>	kg/m	cm	cm <sup>4</sup>	cm <sup>3</sup>	cm	cm <sup>4</sup>	cm <sup>3</sup>	cm
RT 40	—	3.4	2.95	1.26	5.35	1.95	1.25	2.17	1.08	0.8
RT 45	T45/A	4.25	3.34	1.31	8.08	2.53	1.38	3.84	1.71	0.95
RT 50	T50/A	4.75	3.73	1.43	11.24	3.15	1.54	5.25	2.1	1.05
RT 70	T70-2/A	10.52	8.26	2.02	47.43	9.63	2.12	23.13	6.61	1.48
RT 80	—	13.56	10.65	2.32	80.2	14.21	2.44	38.83	9.7	1.69
RF 50	—	7.07	5.55	1.70	17.36	5.26	1.57	7.02	2.81	0.99
RF 70	T70-1/A	9.51	7.47	2.04	41.3	9.24	2.09	18.65	5.35	1.40
RF 70.9	—	11.25	8.83	2.11	52.81	10.79	2.16	24.62	7.03	1.48
RF 75	T75-3/A	10.99	8.63	1.86	40.35	9.29	1.92	26.49	7.06	1.55
RF 65	—	6.24	4.9	1.71	20.09	5.44	1.79	10.92	3.36	1.32
RF 82	T82/A	10.9	8.55	1.98	49.4	10.2	2.13	30.5	7.4	1.67
RF 89	T89/A	15.7	12.3	2.02	59.52	14.25	1.95	52.4	11.8	1.83
RF 90	T90/A	17.25	13.55	2.61	102	20.87	2.43	52.6	11.8	1.75

**Standard Machined Guide Rails**

Monteferro's Standard guide rails are manufactured in standard lengths of 7', 8', 9' and 16'. T70 and T89 rails are also available in 10' lengths. Metric lengths of 5m and 2.5m as well as custom machined and saw cut lengths are also available.

**DIMENSIONS**

All dimensions in inches unless otherwise noted.

Monteferro Code	ISO Code	q <sub>1</sub> lb/ft	b <sub>1</sub>	h <sub>1</sub>	h	k	n	c	g
Tolerances			+/- 0.06	+/- 0.03	+/- 0.004	+0.004, -0			
T70/B	—	6.25	2.75	1.978	1.937	0.625	1	0.375	0.313
T89/B	T89/B	8.27	3.50	2.44	2.402	0.625	1.3125	0.375	0.313
T114/B	—	11.12	4.50	3.50	3.465	0.625	1.5	0.375	0.313
T127-1/B	T127-1/B	11.94	5.00	3.50	3.465	0.625	1.75	0.375	0.313
T127-2/B	T127-2/B	15.11	5.00	3.50	3.465	0.625	2	0.375	0.500
T140-1/B	T140-1/B	18.55	5.50	4.25	4.213	0.748	2	0.5	0.500
T140-2/B	T140-2/B	22.79	5.50	4.02	3.976	1.125	2	0.6875	0.563
T140-3/B	T140-3/B	30.91	5.50	5.00	4.961	1.250	2.25	0.75	0.688

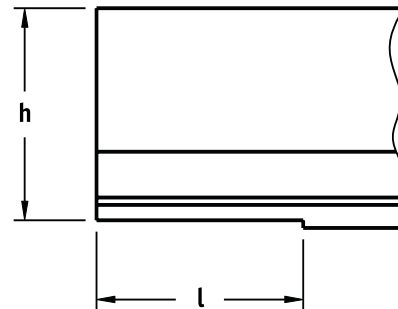
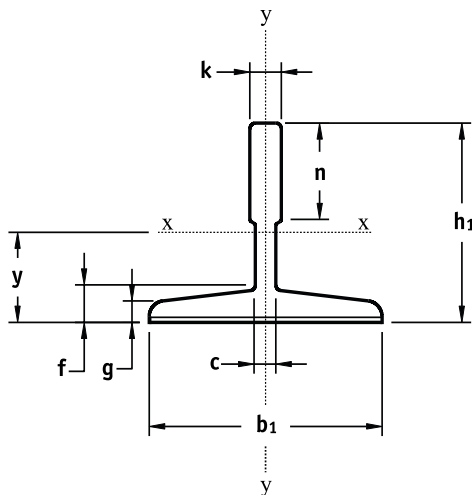

**TOLERANCES**

<p><b>Blade finish</b> longitudinal 1.6 Ra ≤ 63μ in transverse 1.6 Ra ≤ 126μ in</p>	<p><b>Straightness</b> B/A = ± 0.001 in B(@A=MID PT) = ± 0.080 in</p>
<p><b>Twisting</b> γ = 9.1'/ft</p>	<p><b>Parallelism</b> p = 0.004 in</p>
<p><b>Perpendicularity</b> α = 5' β = 15'</p>	<p><b>Tongue and groove centering</b> c = 0.004 in</p>

Guide rails are manufactured in accordance with the ISO 7465: 1997 (E) specification.

f	m <sub>1</sub>	m <sub>2</sub>	t <sub>1</sub>	t <sub>2</sub>	d	d <sub>1</sub>	l	b <sub>3</sub>	l <sub>2</sub>	l <sub>3</sub>
	+0.0025, -0	+0, -0.0025	+/- 0.004	+/- 0.004				+/- 0.008	+/- 0.008	+/- 0.008
0.4375	0.252	0.251	0.281	0.25	0.5625	N/A	6.14	1.813	4.50	1.50
0.4375	0.252	0.251	0.281	0.25	0.5625	1.024	6.14	2.250	4.50	1.50
0.4375	0.252	0.251	0.281	0.25	0.6875	1.299	6.14	2.625	4.50	1.50
0.4375	0.252	0.251	0.281	0.25	0.6875	1.299	6.14	3.125	4.50	1.50
0.625	0.252	0.251	0.281	0.25	0.6875	1.299	6.14	3.125	4.50	1.50
0.625	0.252	0.251	0.281	0.25	0.8125	1.575	7.6	3.625	6.00	1.25
0.6875	0.252	0.251	0.281	0.25	0.8125	1.575	7.6	3.625	6.00	1.25
1.000	0.252	0.251	0.281	0.25	0.8125	1.575	7.6	3.625	6.00	1.25

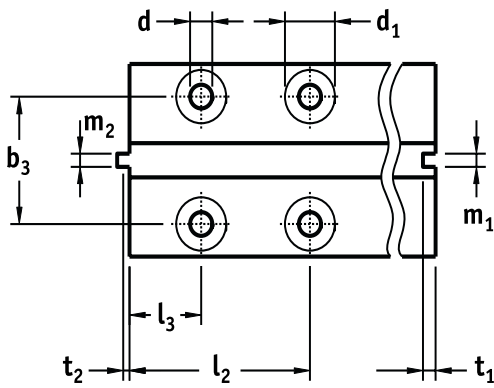

### SECTIONAL PROPERTIES

Monteferro Code	ISO Code	a in <sup>2</sup>	q <sub>1</sub> lb/ft	y in	i <sub>xx</sub> in <sup>4</sup>	z <sub>x</sub> in <sup>3</sup>	r <sub>x</sub> in	i <sub>yy</sub> in <sup>4</sup>	z <sub>y</sub> in <sup>3</sup>	r <sub>y</sub> in
T70/B	—	1.79	6.25	0.67	0.66	0.52	0.60	0.62	0.46	0.59
T89/B	T89/B	2.43	8.27	0.80	1.43	0.87	0.77	1.26	0.72	0.72
T114/B	—	3.22	11.12	1.13	4.30	1.81	1.16	2.59	1.17	0.90
T127-1/B	T127-1/B	3.51	11.94	1.08	4.47	1.86	1.13	3.56	1.43	1.01
T127-2/B	T127-2/B	4.44	15.11	0.97	4.77	1.89	1.04	5.53	2.21	1.11
T140-1/B	T140-1/B	5.46	18.55	1.28	9.71	3.26	1.33	7.45	2.70	1.17
T140-2/B	T140-2/B	6.70	22.79	1.37	10.98	4.15	1.28	8.60	3.12	1.13
T140-3/B	T140-3/B	9.08	30.91	1.72	22.90	6.99	1.59	11.68	4.24	1.13

# Vector inverter for lifts with Asynchronous/Synchronous motors

## ADL300

**Fast installations and commissioning**

Language: English

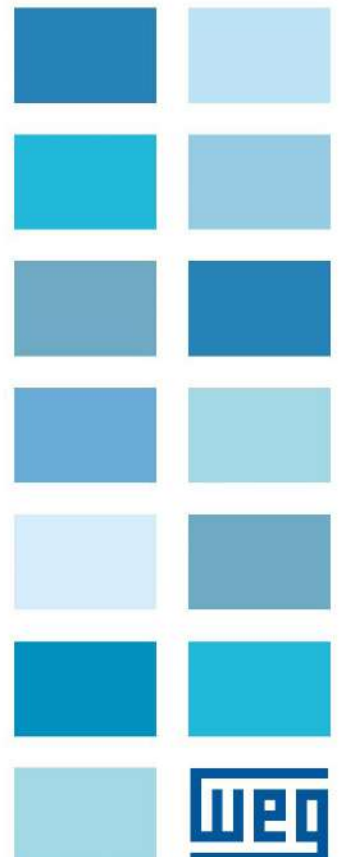



**Data plate**

Serial number	Type : ADL300A-1040-KBL -F-4-C		S/N: 09012345	
Drive model	Inp: 230Vac-480Vac (Fctry set=400) 50/60Hz 3Ph 12.5A@400Vac 11A@480Vac			
Input (mains supply, frequency, AC Input Current at constant torque)	Out : 0-480Vac 300Hz 3Ph 4kW@400Vac 5 Hp @ 460Vac			
Output (Output voltage, frequency, power, current, overload)	9A @400V Ovld . 200%-10s 8.10A@460V Ovld.200%-10s			
Approvals	Made in Italy		0051	CE
	UL LISTED		IND.CONT.EQ.31KF	

**Firmware and card revision plate**

Firmware Release	HW release					S/N 09012345		Prod. CONF
	D	F	P	R	S	BU	SW . CFG	
3.0.0			-R	-D			12.12.13	A1

Power Regulation Safety Braking unit Software revision Product configuration

**Position of plates on the drive**

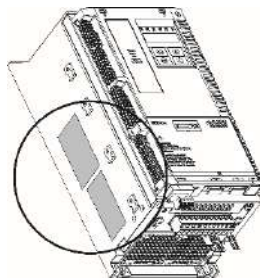

## 4 Electrical Installation

### 4.1 ADL300 Typical Installation and Main Sections

The ADL300 is composed of two parts where the cables must be connected: power section (P-ADL) and regulation section (R-ADL). Here a typical connection schema using phase contactors (for single contactor or contactorless connections see ADL300 Quick Start Manual).

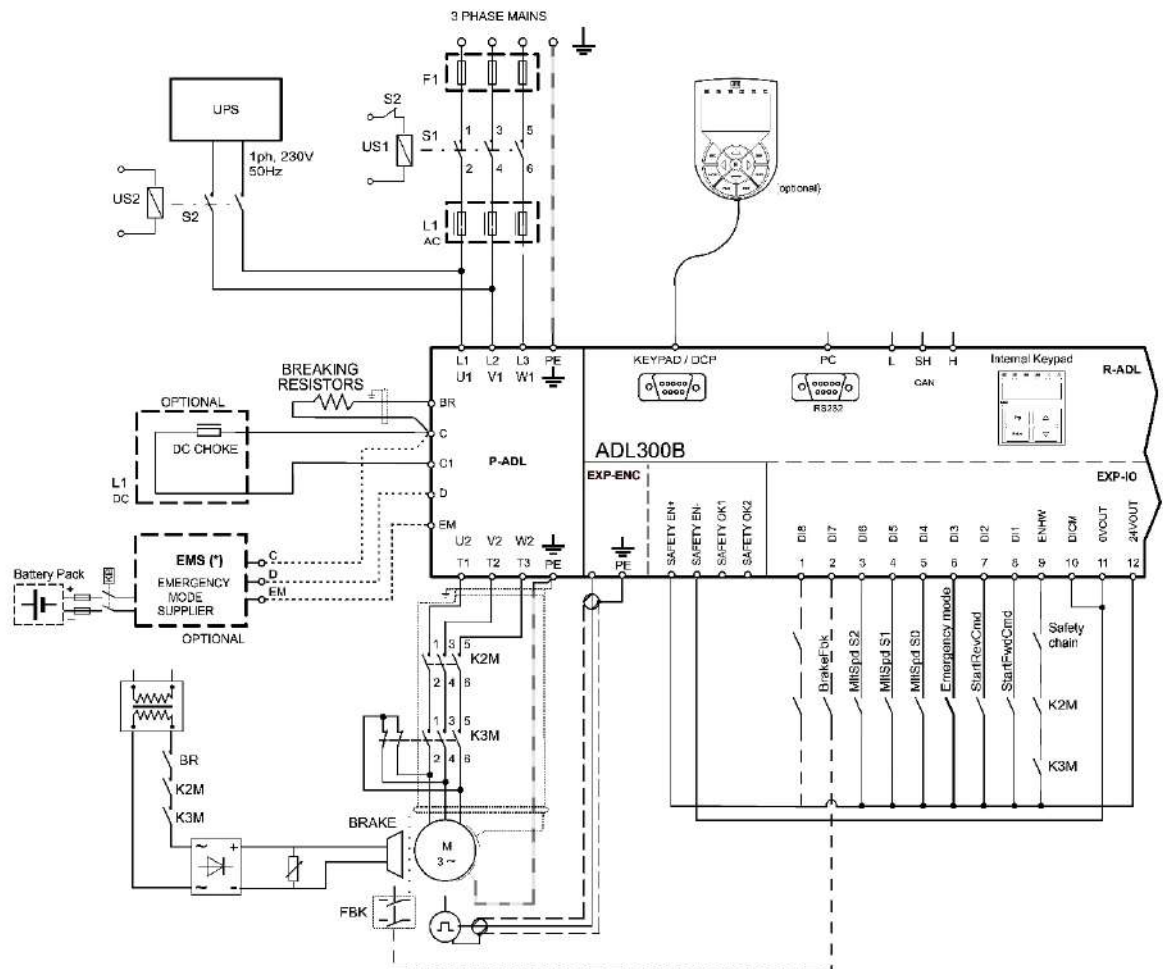

#### 4.1.1 Power Section (P-ADL)

The power section that is supplied by the main and provides the power to the motor. The terminals available in the power section of the drive are the followings:

- L1 - L2 - L3: terminals for connection to the main
- U - V - W: terminals for connection to the motor
- C - D: terminals for direct connection to the DC bus.
- BR: terminal for the connection of the braking resistor
- EM: terminal for the connection of the Emergency system (see chapter 6.7).

## 5 Keypad Operation

### 5.1 KB-ADL optional programming keypad

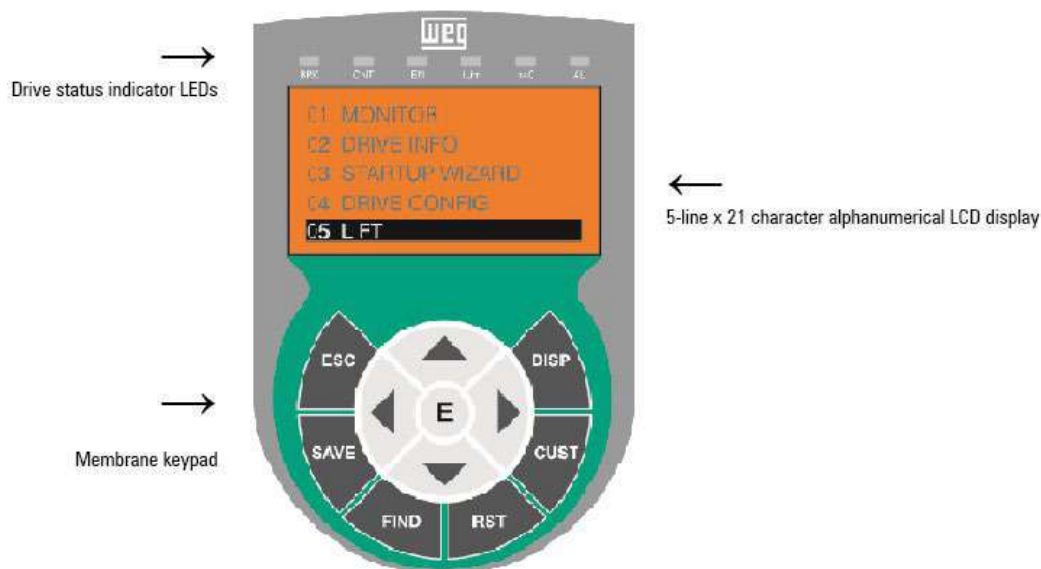

The optional programming keypad is used to display the status and diagnostics parameters during operation. It has a strip of magnetic material on the back so that it can be attached to the front of the drive or other metal surface (e.g. door of the electrical panel). The keypad can be used remotely from distances of up to 15 m. A 70 cm-long connection cable is supplied as standard. Up to 5 sets of parameters can be saved using the KB-ADL keypad and sent to other drives.

#### 5.1.1 Membrane keypad

This section describes the keys on the membrane keypad and their functions

Symbol	Reference	Description
ESC	Escape	Returns to the higher level menu or submenu. Exits a parameter, a list of parameters, the list of the last 10 parameters and the FIND function. Can be used to exit a message that requires use of this.
SAVE	Save	Saves the parameters directly in the non-volatile memory without having to use <b>4.1 Save parameters</b>
FIND	Find	Enables the function for accessing a parameter using its number. To exit these functions, press the ◀ key.
RST	Reset	Resets alarms, only if the causes have been eliminated.
CUST	Custom	Displays the last 10 parameters that have been modified. To exit these functions, press the ◀ key.
DISP	Display	Displays a list of drive functioning parameters.
E	Enter	Enters the submenu or selected parameter, or selects an operation. It is used when modifying parameters to confirm the new value that has been set.
▲	Up	Moves the selection up in a menu or list of parameters. During modification of a parameter, increases the value of the digit under the cursor.
▼	Down	Moves the selection down in a menu or list of parameters. During modification of a parameter, decreases the value of the digit under the cursor.
◀	Left	Returns to the higher level menu. During modification of a parameter, moves the cursor to the left.
▶	Right	Accesses the submenu or parameter selected. During modification of a parameter, moves the cursor to the right.

**LIFT AND ELEVATOR ROPES  
METALLIC CORE ELEVATOR ROPES**

**MULTILIFT 6.5mm**  
"BUREAU VERITAS CERTIFICATE N. BVI23 ASC CV 0001"  
WARRINGTON DESIGN

- 8 Strands at 19 wires warrington
- Metallic core
- Class of strength 1570N/mm<sup>2</sup> or 1770N/mm<sup>2</sup>
- Bright wire
- Elastic module 125 KN/mm<sup>2</sup>
- Elastic elongation of the rope with a load of 10% of its MBL it's 0,132% of rope length

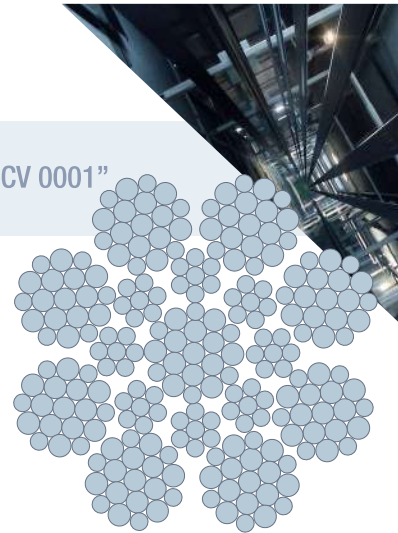

*Why to choose?*  
**MULTILIFT 6.5mm**

- BV APPROVED
- Cost saving
- Very low D/d ratio, D/d >= 18.5
- Suitable for Indirect Hydraulic elevators to save space
- Suitable for steel, cast iron and plastic pulleys
- High performance and longer lasting

**8x19W+IWRC**

ROPE Ø mm	kg/mt	MINIMUM BREAKING LOAD		Metallic section mm <sup>2</sup>
		KN	Kg	
6,5	0,19	32	3.214	22

**LIFT AND ELEVATOR ROPES  
METALLIC CORE**

**MULTILIFT M8W**

- 8 Strands at 19 wires Warrington
- Metallic core
- Class of strength 1570N/mm<sup>2</sup> or 1770N/mm<sup>2</sup>
- Bright wire
- Elastic module 125 KN/mm<sup>2</sup>
- Elastic elongation of the rope with a load of 10% of its MBL it's 0,132% of rope length
- Up to 13mm successfully used as a governor rope

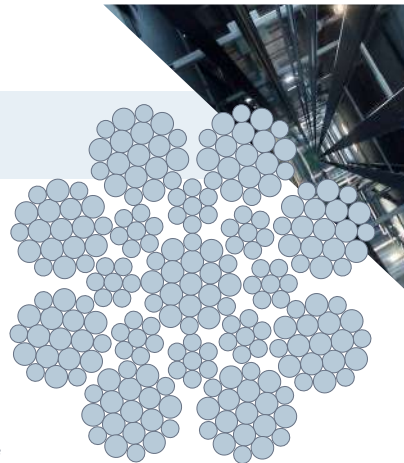

*Why to choose?*  
**MULTILIFT M8W**

- Very high breaking strenght
- Very high flexibility
- High stability

**8x19W+IWRC**

ROPE Ø mm	kg/mt	MINIMUM BREAKING LOAD		Metallic section mm <sup>2</sup>
		KN	Kg	
8	0,28	47	4.755	33
10	0,43	73	7.418	51
13	0,77	114	11.633	88

## LIFT AND ELEVATOR ROPES 9 STRANDS

### MULTILIFT DPS • M9S

- 9 Strands at 19 wires seale
- Metallic core
- Class of strength 1570N/mm<sup>2</sup> or 1770N/mm<sup>2</sup>
- Bright wire
- Elastic module 125 KN/mm<sup>2</sup>
- Elastic elongation of the rope with a load of 10% of its MBL it's 0,132% of rope length

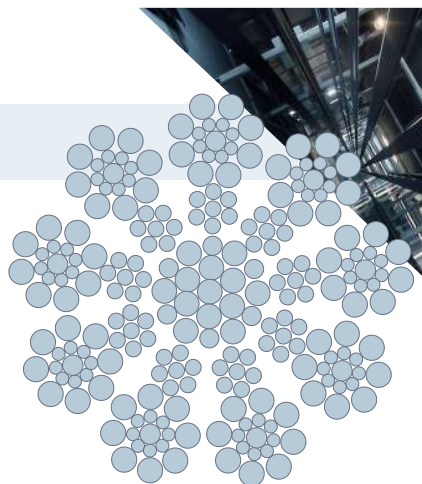

## Why to choose?

### MULTILIFT M9S

- Most efficient solution for very high elevators
- High flexible performance with bending fatigue test
- Low elastic elongation
- Up to 13mm successfully used as a governor rope

### 9x19S+IWRC R.1570N/mm<sup>2</sup>

ROPE Ø mm	kg/mt	Metallic section mm <sup>2</sup>	MBL
8	0,27	21,88	43,2
9	0,34	27,70	56,3
10	0,42	34,19	68
11	0,51	41,38	80,2
13	0,71	57,79	113,4

## LIFT AND ELEVATOR ROPES ELEVATOR ROPES

### STEEL WIRE ROPE MP LIFT

- 8 Strands at 19 wires seale
- Fiber core
- Class of strength 1570N/mm<sup>2</sup>
- Bright wire
- Elastic module 95 KN/mm<sup>2</sup>
- Elastic elongation of the rope with a load of 10% of its MBL it's 0,14% of rope length

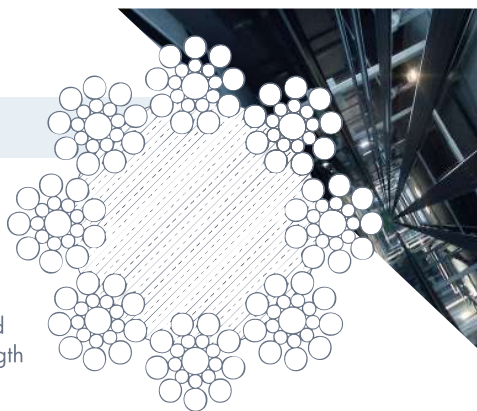

### 8x19S+FC

ROPE Ø mm	kg/mt 0,341	MINIMUM BREAKING LOAD		Metallic section mm <sup>2</sup>
		KN	Kg	
8	0,223	29	3.004	23
9	0,287	37	3.802	30
10	0,337	46	4.694	36
11	0,417	56	5.680	44
12	0,487	66	6.759	53
13	0,588	78	7.933	63
14	0,686	90	9.200	70
15	0,778	104	10.561	80
16	0,845	118	12.017	91

On requests all rope could be produced with double class of strength, R.1770/1370N/mm<sup>2</sup> or in class 1770N/mm<sup>2</sup>



SINCE 1965, IN THE CITY OF SAN BENEDETTO DEL TRONTO, THE ITALIAN FAMILY OF CIANCIABATTONI STARTED TO CREATE A HISTORY, MADE OF PASSION, INNOVATION, CREATIVITY, KNOWLEDGE AND PEOPLE.

A STORY WOVEN BY THREE GENERATIONS, WORKING HARD AND WITH A BIG DETERMINATION FOR 50 YEARS, PROUD OF OUR MANUFACTURING HERITAGE, TRUST, CO-OPERATION, HIGH QUALITY, SAFETY, SERVICE AND FLEXIBILITY ARE ABSOLUTELY OUR SKILLS.

*MP WIRE ROPES* PRODUCTION IS COMPLETELY "MADE IN ITALY" AND ACCORDING *ISO 9001* SINCE 1995.

*MP WIRE ROPES* IS WILLING TO BRING YOU INTO OUR WIRE ROPE FAMILY, ASSURING YOU OF QUALITY AND SERVICE THAT CANNOT BE BEATEN.

## CAVI PER APPLICAZIONI VERTICALI E SISTEMI A FESTIONE VERTICAL APPLICATIONS AND FESTOON SYSTEMS CABLES



### FLAT PVC

Cavo piatto multipolare - PVC/PVC - 300/500 V o 450/750 V.  
Non propagante la fiamma e resistente all'olio  
Flat multi-core cable - PVC/PVC - 300/500 V or 450/750 V.  
Flame retardant and Oil resistant cable

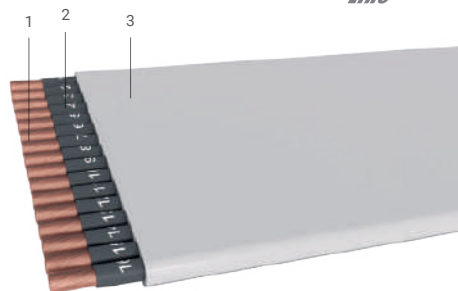

1. Rame flessibile Classe 5 | Flexible copper Class 5 • 2. PVC | PVC • 3. PVC | PVC

#### Applicazioni | Applications

Adatto per uso su sistemi elevatori, ascensori, gru, catene portacavo, sistemi a festone. Suitable for use on lift, elevators, cranes, drag chains, festoon system.

#### Norme | Standards



#### Confezionamento | Packaging



#### Sezione | Section

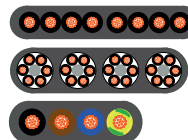

#### Codice colori | Colours code

Bianco numerato o Nero numerato – Giallo / Verde, secondo HD 308  
White numbered o Black numbered – Yellow / Green, according to HD 308

#### Caratteristiche | Characteristics

Tensione d'esercizio   Voltage rating	300/500 V o   or 450/750 V
Resistenza di isolamento min. a 20°C Min. insulation resistance at 20°C	20 Mohm x Km
Resistenza del conduttore max. a 20°C Max. conductor resistance at 20°C	Secondo IEC 60228 According to IEC 60228
Temperatura di esercizio (posa mobile) Temperature rating (mobile installation)	-5°C ÷ +80°C
Temperatura di esercizio (posa fissa) Temperature rating (fixed installation)	-20°C ÷ +80°C
Raggio di curvatura min. (posa mobile) Min. bending radius (mobile installation)	12 x altezza guaina esterna 12 x outer sheath height
Non propagante la fiamma   Flame retardant	IEC 60332-1-2
Resistenza all'olio   Oil resistance	IEC 60811-404
Norme applicabili   Applicable standards	EN 50214 - EN 50363 - EN 50290 (TM54)

#### Configurazioni | Configurations

N° di conduttori x sezione N° of cores x size mm <sup>2</sup>	Diametro esterno Outer diameter mm
4G1,5	5,0x14,7
8G1,5	5,0x30,0
12G1,5	5,0x42,3
16G1,5	5,0x52,4
4G2,5	5,6x17,8
5G2,5	5,6x21,3
8G2,5	5,6x33,5
12G2,5	5,6x49,2
4G4	7,0x22,0
4G6	8,0x26,0
4G10	10,0x31,0
4G16	10,0x34,0
4G25	14,0x45,0
4G35	15,0x50,0
8G6	8,0x42,0

N° di conduttori x sezione <i>N° of cores x size mm<sup>2</sup></i>	Diametro esterno <i>Outer diameter mm</i>
24G1 (4x6x1)	10,0x38,0
24G1 (6x4x1)	11,0x46,0
24G1,5 (4x6x1,5)	10,0x36,0
24G1,5 (6x4x1,5)	11,0x55,0
24G2,5(6x4x2,5)	13,0x63,0
24G0,75+2x(2x0,35) *	5,2x78,2
24G0,75+2x(2x0,50) *	5,2x78,2
24x0,75+2x0,50+1x1,5 *	5,2x78,2

Altre configurazioni su richiesta | *Other configuration on request*  
 \*Tensione di esercizio 300/500 V | *Voltage rating 300/500 V*

Opzionale  
*Optional*



PVC



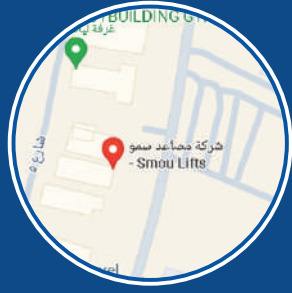

Dubai

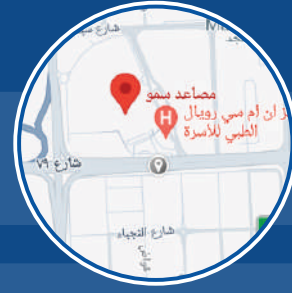

Abu Dhabi



Sharjah

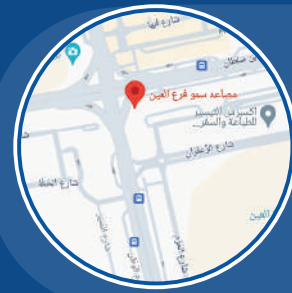

Al Ain

+ 971 50 103 5499

+ 971 60058333

+ 971 55 515 0030

Info@smou.ae - info@smoulift.com

www.smoulift.com

DUBAI

Alnahda 1 - Saheel Tower 1  
Office : 1405  
Mob : + 971 50 103 5499  
Tel : + 971 4 220 8861

ABU DHABI

UAE - Captial mall  
China Centre  
Mob : + 971 55 515 0030  
Tel : + 971 4 880 7113

Al Ain

UAE - Sultan bin zaid street  
Skeikha Salamh Building  
Mob : + 971 50 103 5499  
Tel : + 971 3 761 3136

SHARJAH

UAE - Sultan bin zaid street  
Skeikha Salamh Building  
Mob : + 971 50 103 5499  
Tel : + 971 3 761 3136

Head Office

Kingdom of Saudi Arabia  
Riyadh , Al Sahafa Destrict  
Mob : + 966 56 440 0098  
Tel : + 966 11 222 9151

Al Hasa Branch

Kingdom of Saudi Arabia  
Al-Qetar Street Intersection  
Mob : + 966 54 097 7973  
Tel : + 966 13 573 2730

Dammam Branch

Kingdom of Saudi Arabia  
Zahran St. King Fahd front  
of Dammam pals  
Mob : + 966 54 037 7078

Kuwait - Hawalli

Block 7 Building No.12A  
Mob : + 965 6083 8834  
Tel : + 965 549 3866